

# Lever Operated Butterfly Valve

Lugged - Ductile Iron - 316 SS Disk - EPDM Seat  
WATERMARK

PRODUCT DATASHEET

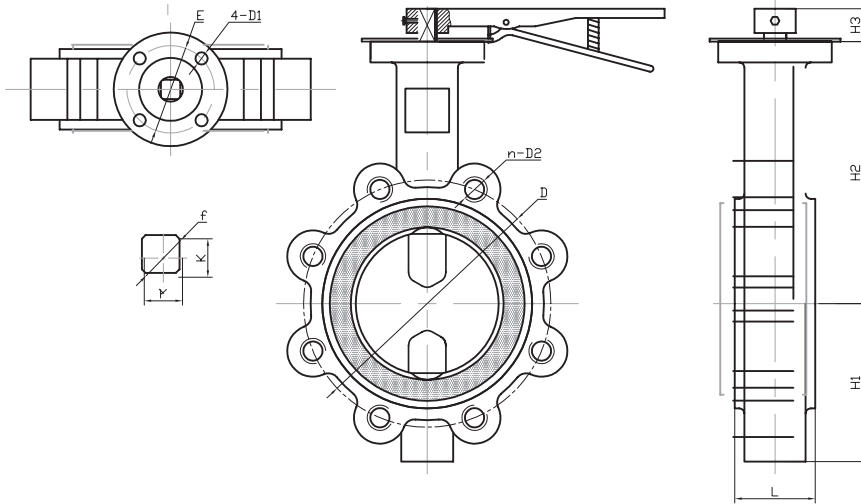

## Specifications

- Max Cold Working Pressure: 1600 kPa (16 Bar)
- Flange drilling is Table E except for the 100mm (4") size, which is drilled Table D & E
- Top Flange: ISO 5211

## Features

- Suitable for water and wastewater treatment and general industry.
- The thin compact butterfly valve body allows for easy installation in tight areas.
- When released the lever locks into position via a notch plate.

## Dimensions (mm)

Imperial Size	H1	H2	H3	D	L	K	E	F	4-D1	N-D2	KG/PC
2"	80	161	31.8	114	42.04	11	70	14.1	10	4-M16	4.73
2 1/2"	89	175	31.8	127	44.68	11	70	14.1	10	4-M16	5.28
3"	95	181	31.8	146	45.21	11	70	14.1	10	4-M16	5.42
4"	114	200	31.8	178	52	14	70	18.1	10	8-M16	8.84
5"	127	213	31.8	210	54.36	17	70	22.1	10	8-M16	11.06
6"	139	226	31.8	235	55.7	17	70	22.1	10	8-M20	13.01
8"	175	260	35.5	292	60.1	17	102	22.1	12	8-M20	20.01
10"	203	292	35.5	356	65.63	22	102	28.2	12	8-M20	29
12"	242	337	35.5	406	76.5	22	102	28.2	12	12-M24	44

## Materials

#	PART	MATERIAL
1	Body	Ductile Iron
2	Lower Bushing	Bronze
3	Stem	Stainless Steel 420
4	Seat	EPDM (Watermark)
5	Disc	Stainless Steel CF8M
6	Long Bushings	PTFE
7	Rivet	L3
8	Tag	Stainless Steel 304
9	Short Bushings	Bronze
10	O-ring	NBR
11	Split Ring	Gr 33
12	Circlip	Gr 33
13	Handle	Cast Iron

## Warranty

24 months

### For Further Information

info@valvewarehouseaustralia.com.au

03 9421 0042

Valve Warehouse ABN 33 632 515 149