

# Lever Operated Butterfly Valve

Wafer - Ductile Iron - 316 SS Disk - EPDM Seat  
WATERMARK

PRODUCT DATASHEET

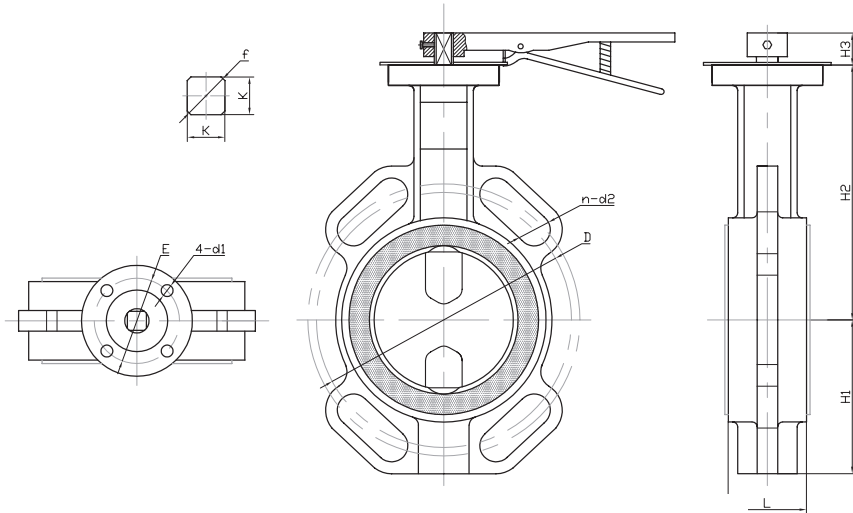

## Materials

#	PART	MATERIAL
1	Body	Ductile Iron
2	Lower Bushing	Bronze
3	Stem	Stainless Steel 420
4	Seat	EPDM (Watermark)
5	Disc	Stainless Steel CF8M
6	Long Bushings	PTFE
7	Rivet	L3
8	Tag	Stainless Steel 304
9	Short Bushings	Bronze
10	O-ring	NBR
11	Split Ring	Gr 33
12	Circlip	Gr 33
13	Handle	Cast Iron

## Specifications

- Max Cold Working Pressure: 1600 kPa (16 Bar)
- Flange drilling is Table E except for the 100mm (4") size, which is drilled Table D & E
- Top Flange: ISO 5211

## Features

- Suitable for water and wastewater treatment and general industry.
- The thin compact butterfly valve body allows for easy installation in tight areas.
- When released the lever locks into position via a notch plate.

## Dimensions (mm)

Imperial Size	H1	H2	H3	D	L	K	F	E	N-D2	4-D1	KG/PC
2"	70	140	31.8	125	42.04	11	14.1	70	4-19	10	3.09
2 1/2"	79	155	31.8	145	44.68	11	14.1	70	4-19	10	3.8
3"	83	160	31.8	160	45.21	11	14.4	70	8-19	10	4.29
4"	107	180	31.8	180	52	14	18.1	70	8-19	10	5.08
5"	127	193	31.8	210	54.36	17	22.1	70	8-19	10	7.1
6"	139	200	31.8	240	55.7	17	22.1	70	8-23	10	8.1
8"	170	240	35.5	295	60.1	17	22.1	102	12-23	12	14
10"	200	272	35.5	355	65.63	22	28.2	102	12-28	12	21
12"	242	317	35.5	410	76.5	22	28.2	102	12-28	12	34

## Warranty

24 months

### For Further Information

info@valvewarehouseaustralia.com.au

03 9421 0042

Valve Warehouse ABN 33 632 515 149