

# Wafer Check Valve Single Wafer

316 Stainless Steel Disk & EPDM Seat

PRODUCT DATASHEET

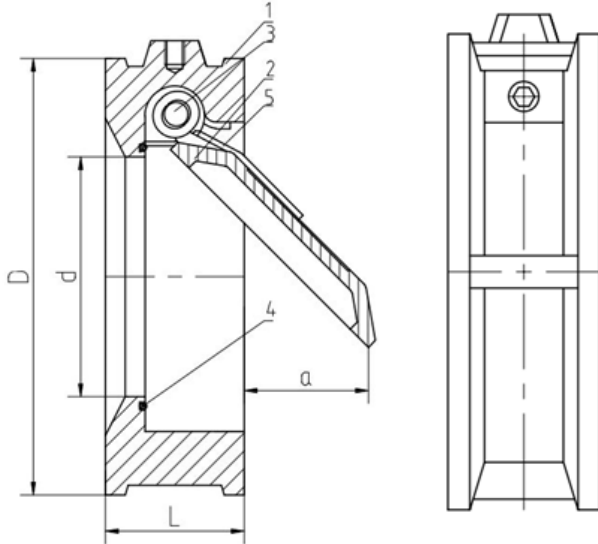

## Features

- Suitable for water, oil and general industry
- The thin compact wafer check valve body allows for easy installation in tight areas
- The check valve requires back pressure to fully seal
- At installation the arrow on the body of the check valve should be pointing in the same flow direction
- The single disc helps to prevent debris getting stuck in the valve compared to the dup check reducing the risk of blockages

## Specifications

- Max Cold Working Pressure: 1600 kPa (16 Bar)
- Flange Drilling: Table E AS2129
- Max Working Temperature: 120°C
- Fusion Bonded Epoxy (FBE) coated

## Dimensions (mm)

Size	L	a	d	D	Class
50mm (2")	44.5	29	31	96	PN16
65mm (2 1/2")	48	30	40	109	PN16
80mm (3")	51	56	49	128	PN16
100mm (4")	57.2	75	73	156	PN16
125mm (5")	69.2	85	89	213	PN16
150mm (6")	73	156	155	267	PN16
200mm (8")	79.4	187	188	328	PN16
250mm (10")	85.7	222	235	375	PN16
300mm (12")	108	229	267	444	PN16
350mm (14")	108	248	318	495	PN16
400mm (16")	108	300	356	558	PN16
450mm (18")	140	324	387	615	PN16
500mm (20")	152	387	483	723	PN16

## Materials

#	PART	MATERIAL
1	Body	Ductile Iron
2	Disc	Stainless Steel CF8M
3	Stem	Stainless Steel 420
4	Seat	EPDM
5	Spring	Stainless Steel 316

## Warranty

24 months

### For Further Information

📧 [info@valvewarehouseaustralia.com.au](mailto:info@valvewarehouseaustralia.com.au)

☎ 03 9421 0042

Valve Warehouse ABN 33 632 515 149